

# Luminette® Privacy Sheers Standard Side Stack

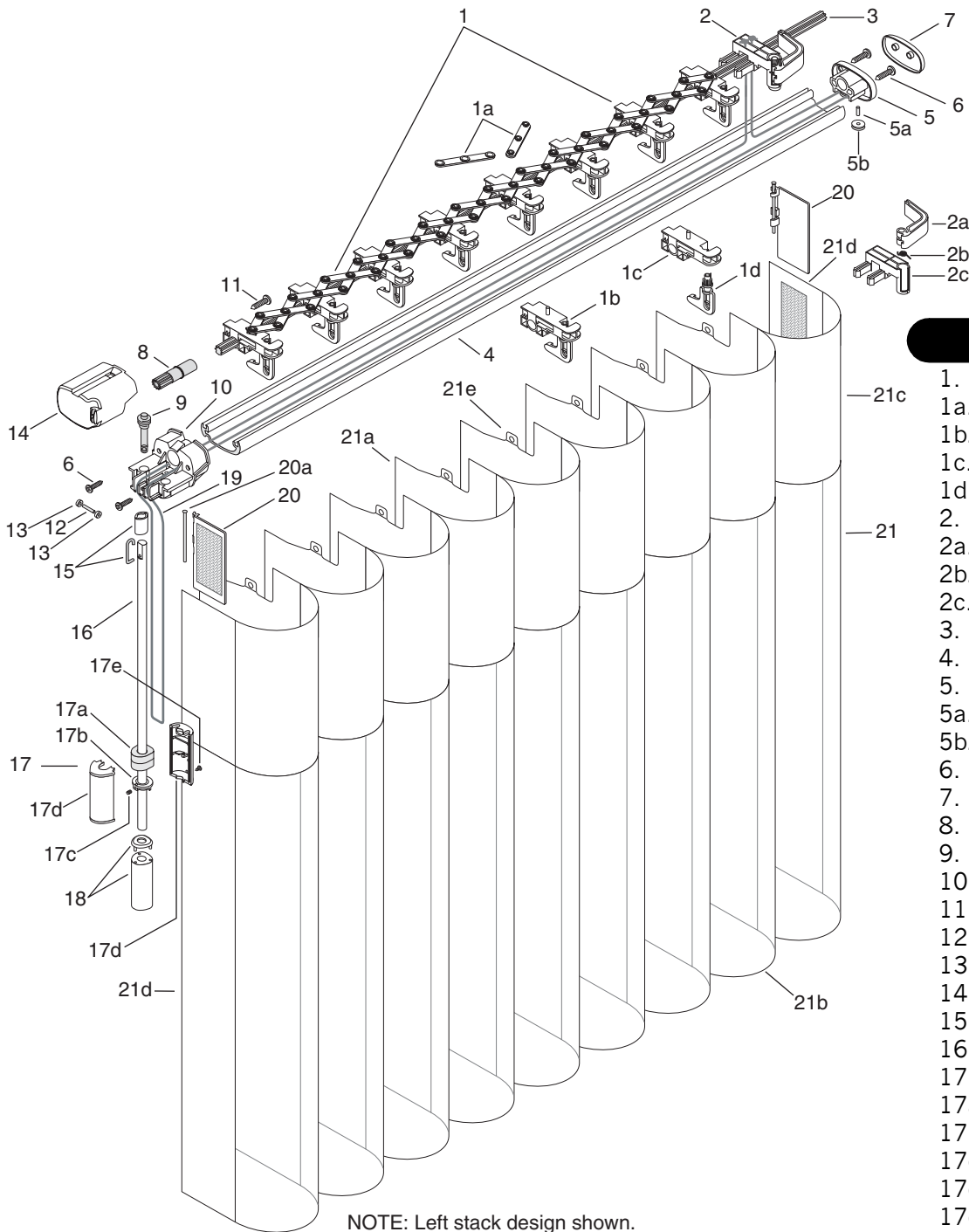

NOTE: Left stack design shown.  
Fabric stacks on the wand side of the sheer.

## Standard Parts

1. Fabric Carrier Group Assembly
- 1a. Scissors
- 1b. Carrier Body Assembly
- 1c. Carrier Body
- 1d. Tilt Reduction Pinion Clip
2. Lead Carrier Assembly
- 2a. Lead Carrier Swivel Arm
- 2b. Lead Carrier Swivel Arm Spring
- 2c. Lead Carrier
3. Tilt Rod Extrusion
4. Headrail
5. Passive End Cap Assembly
- 5a. SS Dowel Pin
- 5b. End Cap Wheel
6. Square Pan Head Screw
7. Passive End Cap Cover
8. Tilt Drive Gear
9. Tilt Drive Worm Gear
10. Universal Bulkhead Body
11. Square Head Hi-Lo Screw
12. Active SS Dowel Pin
13. Cord Pulley
14. Universal Bulkhead Cover
15. Wand Hook with Hook Cover
16. Wand
17. Weighted Tether Control
- 17a. Cord Tether Weight Assembly
- 17b. Cord Tether Locking Ring
- 17c. Cord Tether Set Screw
- 17d. Cord Tether Cover
- 17e. Screw
18. Wand Handle & Cover
19. Cord
20. End Treatment Swivel Plate Assembly
- 20a. Rivet (Double-flared)
21. Fabric
- 21a. Fabric Vane
- 21b. Fabric Face
- 21c. Fabric Valance
- 21d. Fabric End Treatment
- 21e. Polytab

# Luminette® Privacy Sheers Standard Side Stack

<b>No.</b>	<b>PCN</b>	<b>Description</b>	<b>No.</b>	<b>PCN</b>	<b>Description</b>
1.	4250355000	Fabric Carrier Group Assembly with Tilt Reduction Pinion Clip	16.	4250090000	Wand 21" Standard
1a.	4250076000	Scissors (Male and Female)		4250092000	Wand 38" Standard
1b.	N/A	Carrier Body Assembly		4250093000	Wand 48" Standard
1c.	N/A	Carrier Body		4250095000	Wand 68" Standard
1d.	N/A	Tilt Reduction Pinion Clip		4250091000	Wand 28" Non-Standard
2.	4250127xxx	Lead Carrier Assembly RH		4250094000	Wand 58" Non-Standard
	4250128xxx	Lead Carrier Assembly LH		4250096000	Wand 78" Non-Standard
2a.	N/A	Lead Carrier Swivel Arm (RH/LH specific)		4250097000	Wand 88" Non-Standard
				4250098000	Wand 96" Non-Standard
2b.	N/A	Lead Carrier Swivel Arm Spring		4250110000	Wand 120" Non-Standard
2c.	N/A	Lead Carrier (RH/LH specific)		4250111000	Wand 144" Non-Standard
3.	N/A	Aluminum Tilt Rod Extrusion - 12'	17.	4250150xxx	Weighted Tether Control Assembly
	N/A	Brass Tilt Rod Extrusion - 16'			
4.	4250010xxx	Headrail - 16'	17a.	N/A	Cord Tether Weight
5.	4250108xxx	Passive End Cap Assembly	17b.	N/A	Cord Tether Locking Ring
5a.	N/A	SS Dowel Pin 3/32" x .21"	17c.	N/A	Cord Tether Set Screw
5b.	N/A	End Cap Wheel	17d.	N/A	Cord Tether Cover
6.	4250212000	#6 x 1/2" Square Pan Head Tapping (End Cap) Screw	17e.	N/A	Screw 4 x 1/4"
7.	4250109xxx	Passive End Cap Cover	18.	4250107xxx	Wand Handle & Cover
8.	4250058000	Tilt Drive Gear	19.	4250050000	D26 Cord - White
9.	4250051000	Tilt Drive Worm Gear	20.	4250120xxx	End Treatment Swivel Plate Assembly w/Velcro® RH
10.	4250011xxx	Universal Bulkhead Body		4250121xxx	End Treatment Swivel Plate Assembly w/Velcro® LH
11.	4250146000	Square Head Hi-Lo 6-19 x 3/4" (Stationary Carrier) Screw	20a.	N/A	Rivet (1.5" Copper Nickle, Double-flared)
12.	4250048000	Active SS Dowel Pin 3/32" x .5"			
13.	4250047000	Cord Pulley	21.	N/A	Luminette® Fabric: K1, K2, K3, K5, K6, K7, K8, K9, K12, K13, & K14
14.	4250012xxx	Universal Bulkhead Cover			
15.	4250062xxx	Wand Hook with Hook Cover	21a.	N/A	Fabric Vane
			21b.	N/A	Fabric Face
			21c.	N/A	Fabric Valance
			21d.	N/A	Fabric End Treatment
			21e.	N/A	Polytab

## Additional Hardware:

(For pictures & specifics, see Luminette® Privacy Sheers Standard Additional Hardware)

4250085xxx	Ceiling Mount Bracket Kit
4250084xxx	Installation Bracket Kit
4250081xxx	Spacer Block (With Bushings)
4250082xxx	Extension Bracket Cover Kit (Includes Extension Brackets)

xxx = 3-digit color code